

Glass Block Solar Wall Tubes

Solar Wall Tubes are an easy and aesthetically pleasing way to let light into a building that is built with multi-wythe walls. The Solar Wall Tubes replace standard masonry units and allows light transmission for LEED contribution. Daylighting is increasingly important in buildings today. The more daylight that enters a room, the less energy needed by the electrical systems in the building. Daylighting also has a positive effect on mood, atmosphere, and productivity.

Superior Thermal Performance

Solar Wall Tubes from Pittsburgh Corning are available in various sizes with your choice of privacy levels. They are thermally broken and thus provide improved thermal performance. They are easy to install and are self-supporting when installed in a running bond wall. Do not install in stack bond CMU walls unless a lintel is provided.

Solar Wall Tubes are available in 8" and 16" modules in various depths to meet wall thickness requirements.

Maximum Daylighting

Solar Wall Tubes are perfect for commercial building walls where you want to bring in light without compromising the masonry look and feel of the building. The Glass Block Solar Wall Tubes mirror-like finish magnifies and reflects the light and solves many design issues related to single or double glass block installations in multi-wythe wall construction. It allows the architectural look of a single or double glass blocks on both sides of a thick wall. It provides a visually aesthetic look in the hollow area between the glass blocks. The sturdiness of the metal tube prevents any loading from above the opening being transferred to the glass block.

As with single unit glass blocks, installation includes proper sealing between the edges of the wall and the tube on both the exterior and interior walls.



Fort Hamilton - Gebhart Center, Cincinnati, OH // FOCUS™ Pattern

Test Results of the Solar Wall Tubes Are as Follows:

| Solar Wall Tube Description | U-Value | R-Value |
|---|---------|---------|
| 8"x16" solar wall tube with double hollow glass block | 0.21 | 4.76 |
| 8"x16" solar wall tube with double solid glass block | 0.26 | 3.85 |
| 8"x8" solar wall tube with single hollow glass block | 0.27 | 3.70 |
| 8"x8" solar wall tube with single solid glass block | 0.33 | 3.03 |

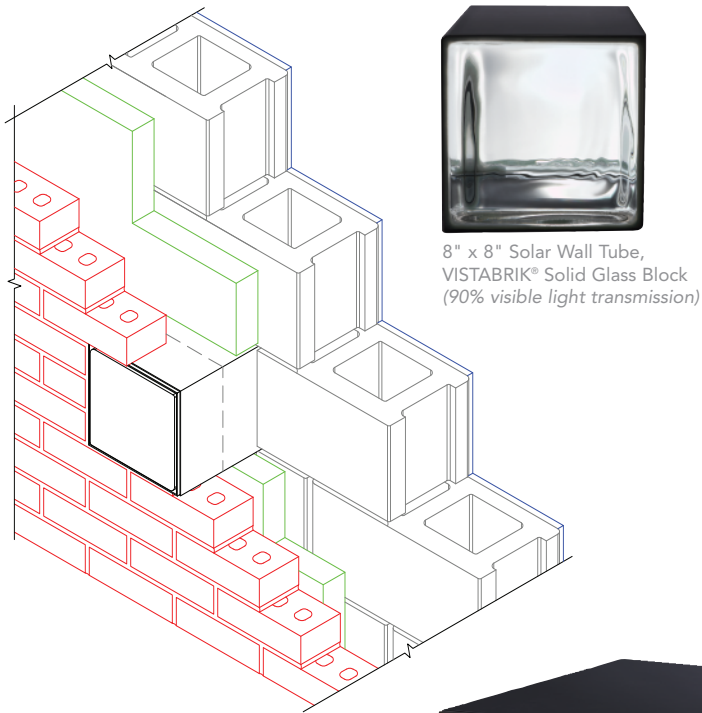

8" x 8" Solar Wall Tube,
VISTABRIK® Solid Glass Block
(90% visible light transmission)

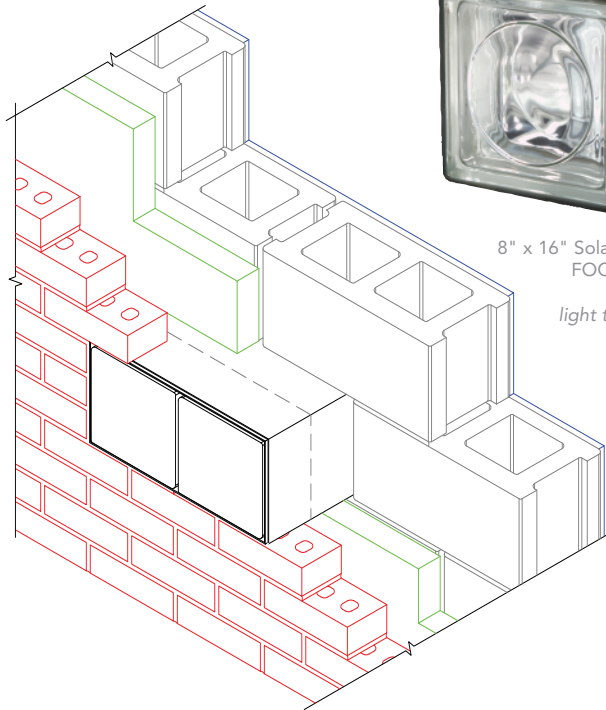

8" x 16" Solar Wall Tube,
FOCUS™ Pattern
(92% visible light transmission)

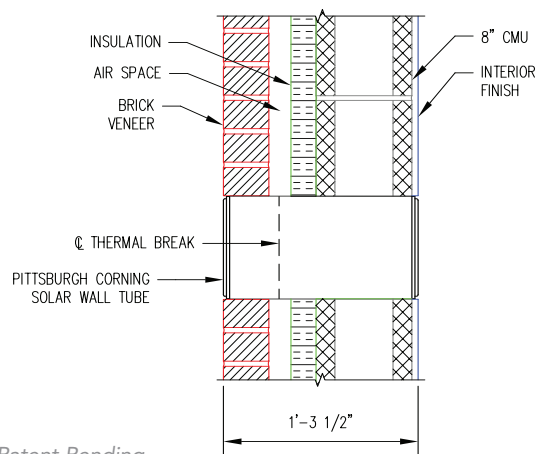

Patent Pending.



Fort Hamilton - Gebhart Center, Cincinnati, OH // FOCUS™ Pattern
Champlin/Haupt Architects, Inc.

Pittsburgh Corning has a sales and technical support team that is ready to help you design, engineer and specify glass block solutions. Please visit our website at pittsburghcorning.com or call 800-871-9918 for assistance.



PITTSBURGH CORNING™

PITTSBURGH CORNING CORPORATION
800 Presque Isle Drive
Pittsburgh, PA 15239-2799
pittsburghcorning.com

© 2009 PITTSBURGH CORNING CORPORATION
All trademarks and registered trademarks in this publication are owned and protected by Pittsburgh Corning Corporation, Pittsburgh, PA 15239

MADE IN AMERICA 

Printed in U.S.A. GB-327 10M 9/09